



YPL
STREET FURNITURE

Tel. +44 (0)1977 600999

Fax. +44 (0)1977 600555

Email. sales@ypl-streetfurniture.co.uk

Web. www.ypl-streetfurniture.co.uk

product specification

code

YPL1UM363WS

description

Delta XXI Chair

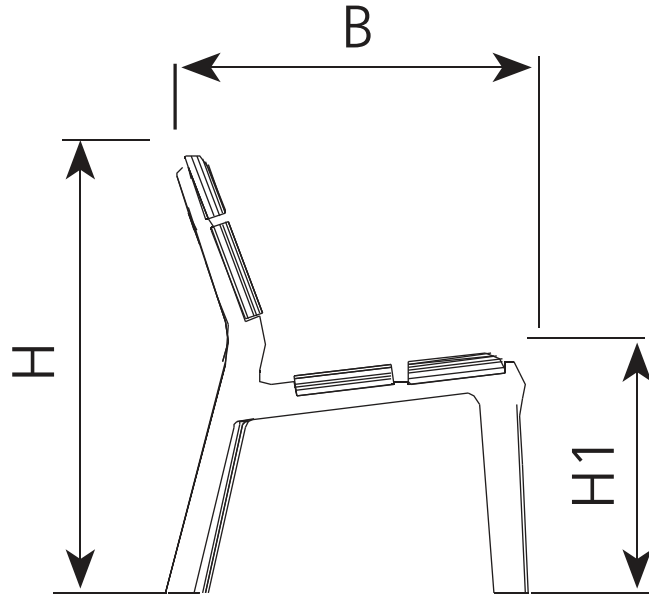
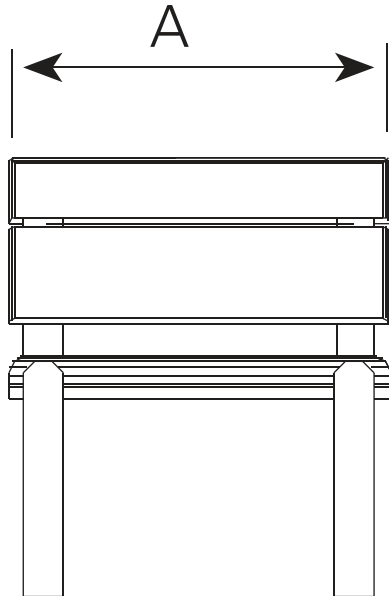

REFERENCE	A	B	H	H1
	650	700	855	450

details

Material: Ductile iron legs; 3 tropical wooden slats of 190x40mm and one slat of 130x40mm. Stainless steel screws.

Finishing: The legs are treated with a process which guarantees a high resistance to corrosion. Grey forge colour finish. The slats treated with a preventive product and fungicide, insecticide and water proofed. Natural colour finished.

Recommended Anchorage: M10 fixing bolts for surface mounting, depending on the surface and the project.

Optional: FSC certified tropical wood can be used if desired. Patented Model.

notes

